

# PROJECT INFORMATION

**APPLICANT:**  
PETER HOLDEN

**DRAWINGS BY:**  
ECCO DESIGN INC.  
7413 GREENWOOD AVE N  
SEATTLE, WA 98103  
206-706-3937

**SITE ADDRESS:**  
5008 E MERCER WAY  
MERCER ISLAND, WA 98040

**PARCEL NUMBER:**  
192405-9247

**BODY OF WATER:**  
LAKE WASHINGTON

**LEGAL DESCRIPTION:**  
BAAP ON S LN OF GL 1 IN NE 1/4 AKA NXN NLY  
PROD OF C/L OF BUTTERWORTH RD WITH SD S  
LN SD PT LOC S 1295.08 FT & W 72.58 FT FR MDR  
COR ON N LN OF SD GL TH NLY ALG CURVE LFT  
CTR OF WCH LIES N 68-03-39 W 542.30 FT ARC  
DIST 96.42 FT TH N 11-45-07 E 367.31 FT TH N  
88-03-30 W 130.44 FT TH N 36-25-12 W 151.36 FT  
TO TPOB TH N 88-24-56 W ALG N LN OF S 580.00  
FT OF SD GL 84.06 FT TH N 13-28-01 E 122.60 FT  
TH S 88-44-44 E ALG N LN OF S 700.00 FT OF SD  
GL 173.51 FT TH S 02-38-45 E 91.21 FT TH S  
88-24-56 E ALG N LN OF S 610.00 FT OF SD GL TO  
SH LN TH SLY TAP S 88-24-56 E OF TPOB TH N  
88-24-56 W TO TPOB LESS S 15.00 FT IN WIDTH &  
SH LDS ADJ ON E

**PROJECT DESCRIPTION:**  
PERMIT AN EXISTING BOAT LIFT.

# VICINITY MAP

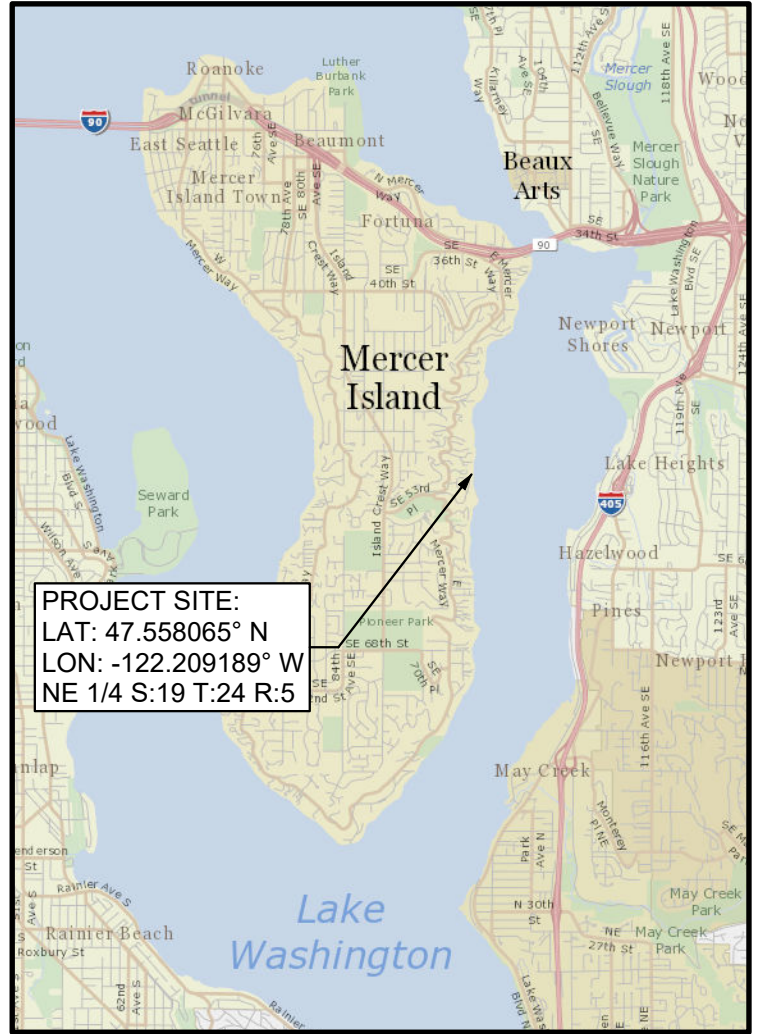

**PROJECT SITE:**  
LAT: 47.558065° N  
LON: -122.209189° W  
NE 1/4 S:19 T:24 R:5

## REFERENCE:

**DATUM:** C.O.E. Locks Datum

## ADJACENT PROPERTY OWNERS:

1. Rod Zorotovich
2. Kasey & Kristin Keller

**APPLICANT:** Peter Holden

**LOCATION:** 5008 E Mercer Way  
Mercer Island, WA 98040

**LAT/LONG:** 47.558065°/-122.209189°

## PROPOSED PROJECT:

Boat Lift  
**IN:** Lake Washington  
**NEAR/AT:** Mercer Island  
**COUNTY:** King **STATE:** WA

**SHEET** 1 of 4

**DATE:** February 5, 2026

PLEASE NOTE THAT THE SHORELINE CONFIGURATION AND PROPERTY LINE LOCATIONS ARE APPROXIMATE ONLY. PROPERTY LINES ARE BASED ON KING COUNTY GIS.

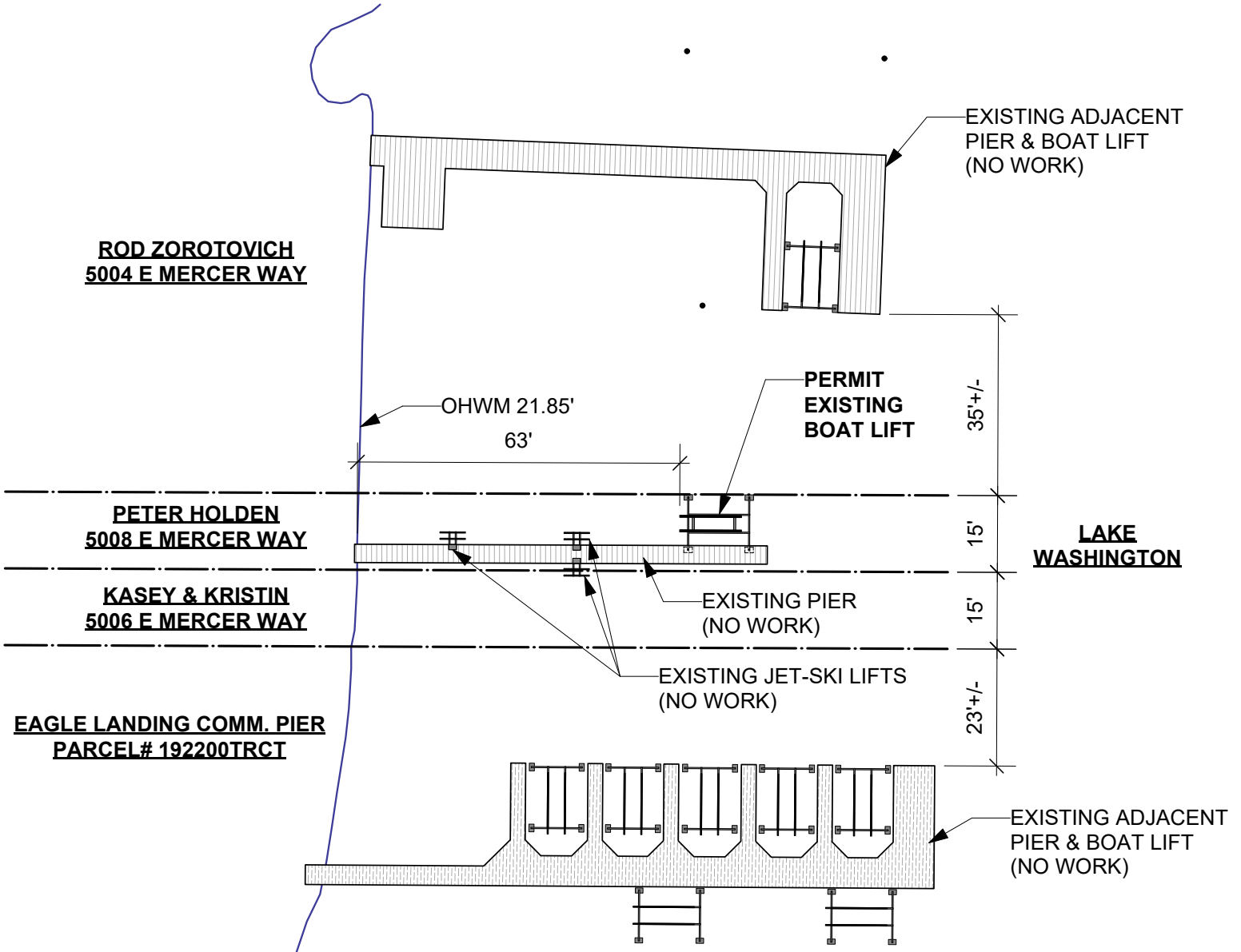

# SITE PLAN

SCALE 1" = 30'-0"



**Reference:**  
**Applicant:** Peter Holden

**Proposed:** Boat Lift  
**Location:** Mercer Island, WA

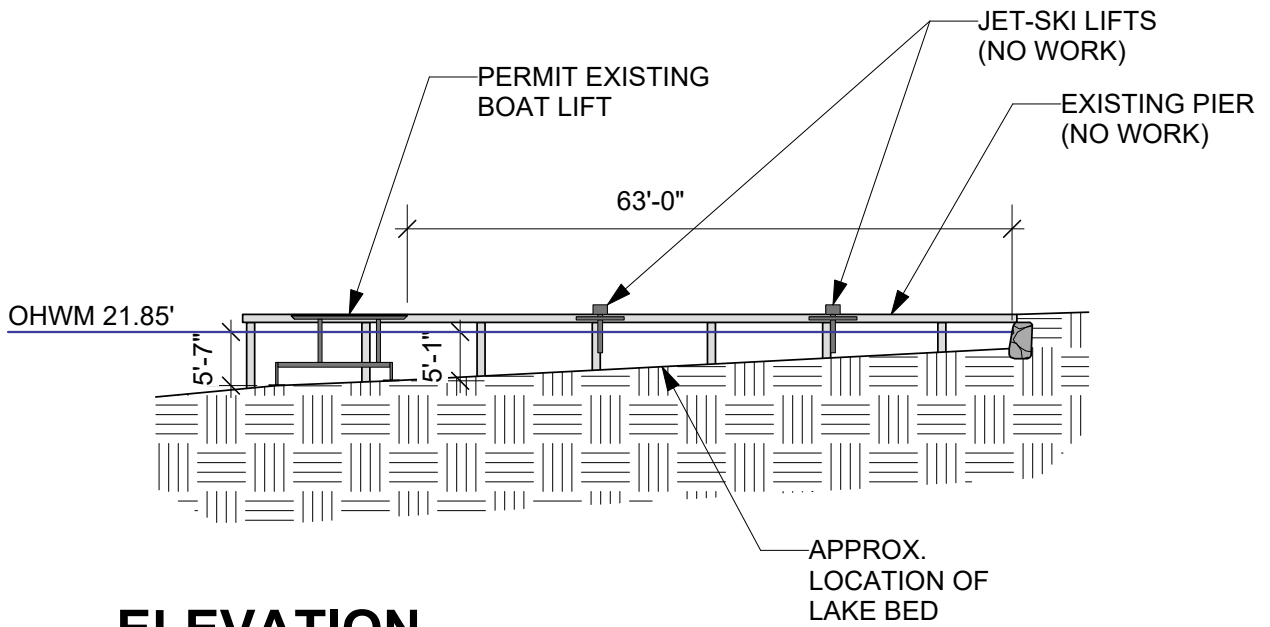

# **ELEVATION**



SCALE 1" = 20'-0"



**Reference:**  
**Applicant:** Peter Holden

**Proposed:** Boat Lift  
**Location:** Mercer Island, WA

## PLANTING LEGEND

-  SNOWBERRY (2 TOTAL)
-  RED-FLOWERING CURRANT (3 TOTAL)

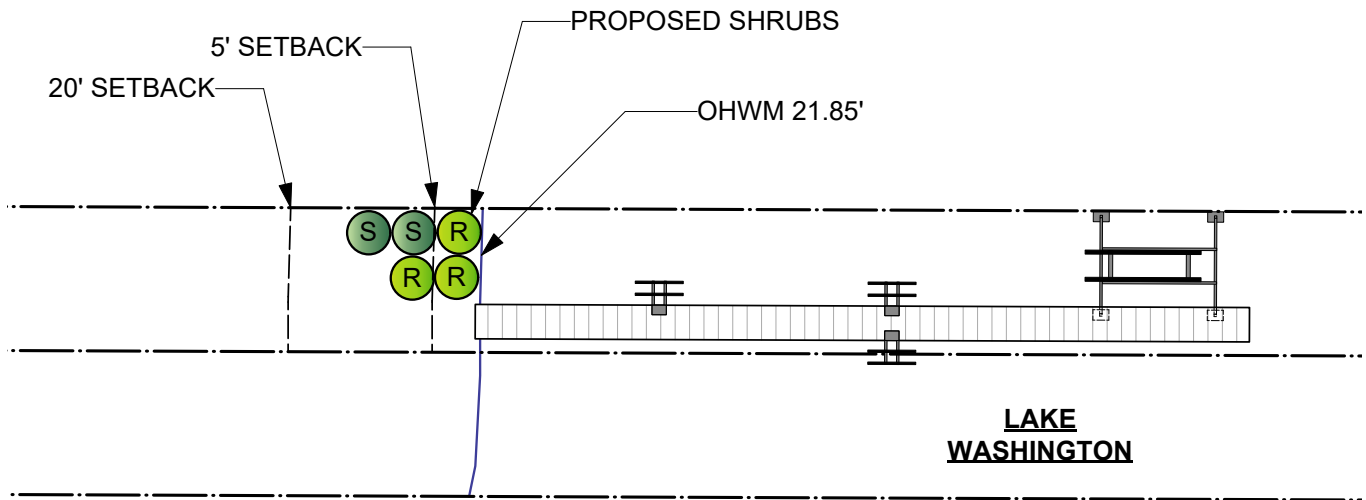

### PLANTING COVERAGE CALCULATIONS

NATIVE PLANT COVERAGE WITHIN THE 5' SETBACK = 45%

PLANT COVERAGE WITHIN THE 20' SETBACK = 27%



## PLANTING PLAN

SCALE 1" = 20'-0"



**Reference:**  
**Applicant:** Peter Holden

**Proposed:** Boat Lift  
**Location:** Mercer Island, WA

**Sheet 4 of 4**    **Date:** 2/5/2026